

4.4

ROUGH OPENING RENOVATION WITH BUILDING WRAP

metal studs with gypsum sheathing/OSB sheathing/plywood

Remove the existing window, flashing and water-resistive barrier to expose the rough opening. Repair the rough opening as required.

Consolidate and seal any new, cut gypsum board edges within the rough opening by brushing on a thin uniform coat of **PorousPrep**.

Wet-set a properly sized and adhesion-compatible transition sheet, such as Moiststop PF, into the wet **FastFlash**. Apply additional **FastFlash** to the leading edge of the transition sheet.

After preparing the rough opening pursuant to 4.1 or 4.2, use a dry joint knife, trowel or chipper brush to spread the **FastFlash** to create a seamless flashing membrane. To protect the rough opening, make sure the membrane extends 9 inches - or as necessary to reach no less than 4 inches beneath any existing building wrap - over the face of the structural wall on the head and jambs.

Spread the wet product to embed that edge of the transition sheet and down over the transition sheet 2" to create a seamless flashing transition.

Shingle the transition sheet to create no less than a 6-inch lap over the existing building wrap.

STEP ONE

Wet-set the transition sheet to wall 1/4" under the sill with **FastFlash**

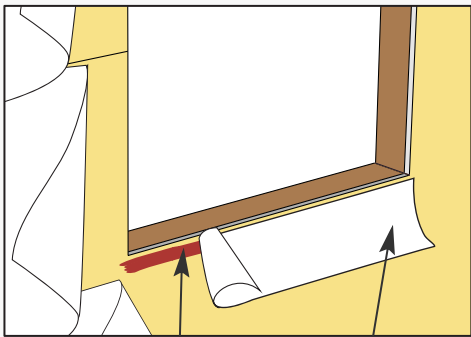

FastFlash Transition Sheet

STEP TWO

Prepare rough opening pursuant to 4.1A or 4.2

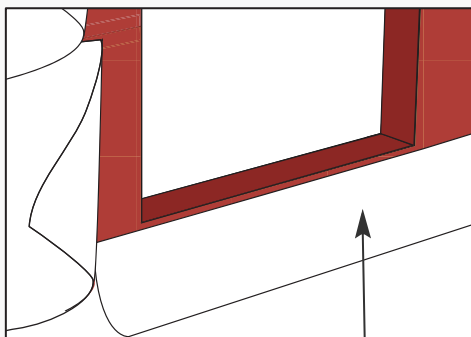

Transition Sheet

STEP THREE

