

# 20.1 INSIDE CORNER DETAIL

## SS ThruWall Flashing

Install the preformed outside corner by applying **FastFlash** on to cast-in-place (CIP) haunch footer. Set the preformed outside corner into wet **FastFlash** to secure to the CIP structure.

Prior to installation of **SS ThruWall** flashing, install **FastFlash** on the horizontal ledge of the CIP footer and over the preformed corner to secure the flashing to the structure. At the outside corner overlap condition of **SS ThruWall**, remove the vertical folded sheet area to accommodate the placement installation and sealant bead detailing to seal the interface between the flashing sheets and preformed corner.

Install **SS ThruWall** onto the CIP haunch footer by wet-setting flashing into the **FastFlash**. In order for the flashing to be adequately bonded to the structure, roll over the flashing to set into wet **FastFlash** with a laminate roller.

Seal vertical/horizontal edges with **FastFlash**. Tool joint interface smooth.

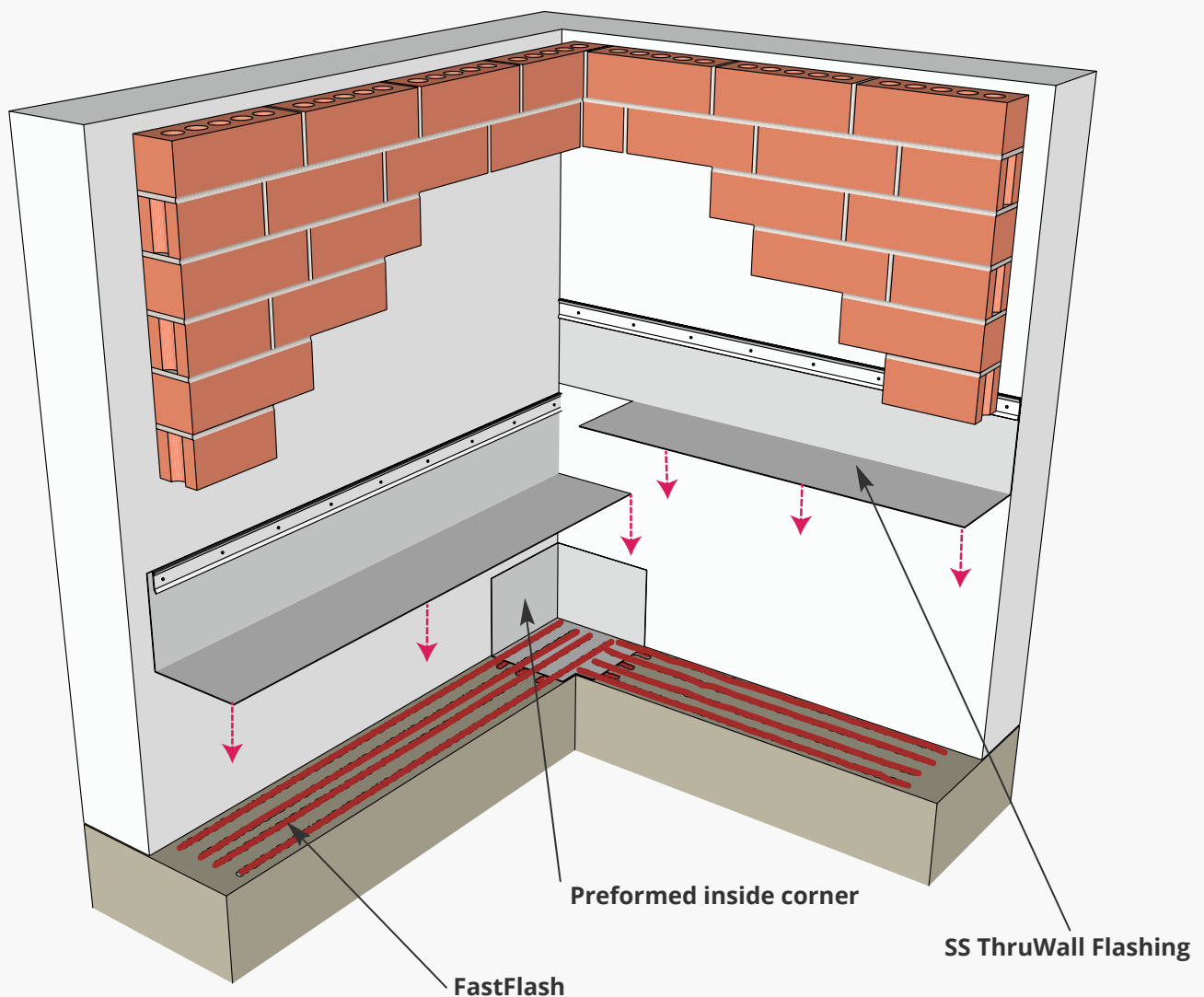

Primary and accessory products not shown for clarity