



PROSOCO®

R-Guard®

AIR & WATER BARRIERS

Termination at Grade - Stucco - S10.1

Sheathing Wall Construction with gypsum, plywood or OSB sheathing.

***Note:** Below-grade waterproofing should be in place prior to application of an R-Guard membrane. Transition interface should be cleaned prior to air barrier application.

Install non-gassing polyethylene foam backer rod (SofRod) into joint at foundation-to-wall interface. Apply enough **FastFlash** or **Joint & Seam Filler** to sufficiently fill the joint to allow for tooling of excess sealant onto the sheathing and the foundation waterproofing, approximately 2 inches on either side. **DO NOT** spread product beyond the flange edge of the weep screed.

Roller or spray apply **Cat 5** over cured sealant and onto sheathing board in preparation to install weep screed. Wet-set vertical flange

of weep screed into **FastFlash** or **Joint & Seam Filler**, then secure screed with fasteners over cured **Cat 5** on sheathing board. Seal top of vertical flange with a bead of **Joint & Seam Filler** and tool smooth.

Trade sequencing may make wet-setting impractical, and it is not required.

Apply an additional coat of **Cat 5** over the **Joint & Seam Filler**, tying into the in-place **Cat 5** membrane to complete the detail.

Install paper-backed metal lath in preparation for the scratch coat application of stucco.

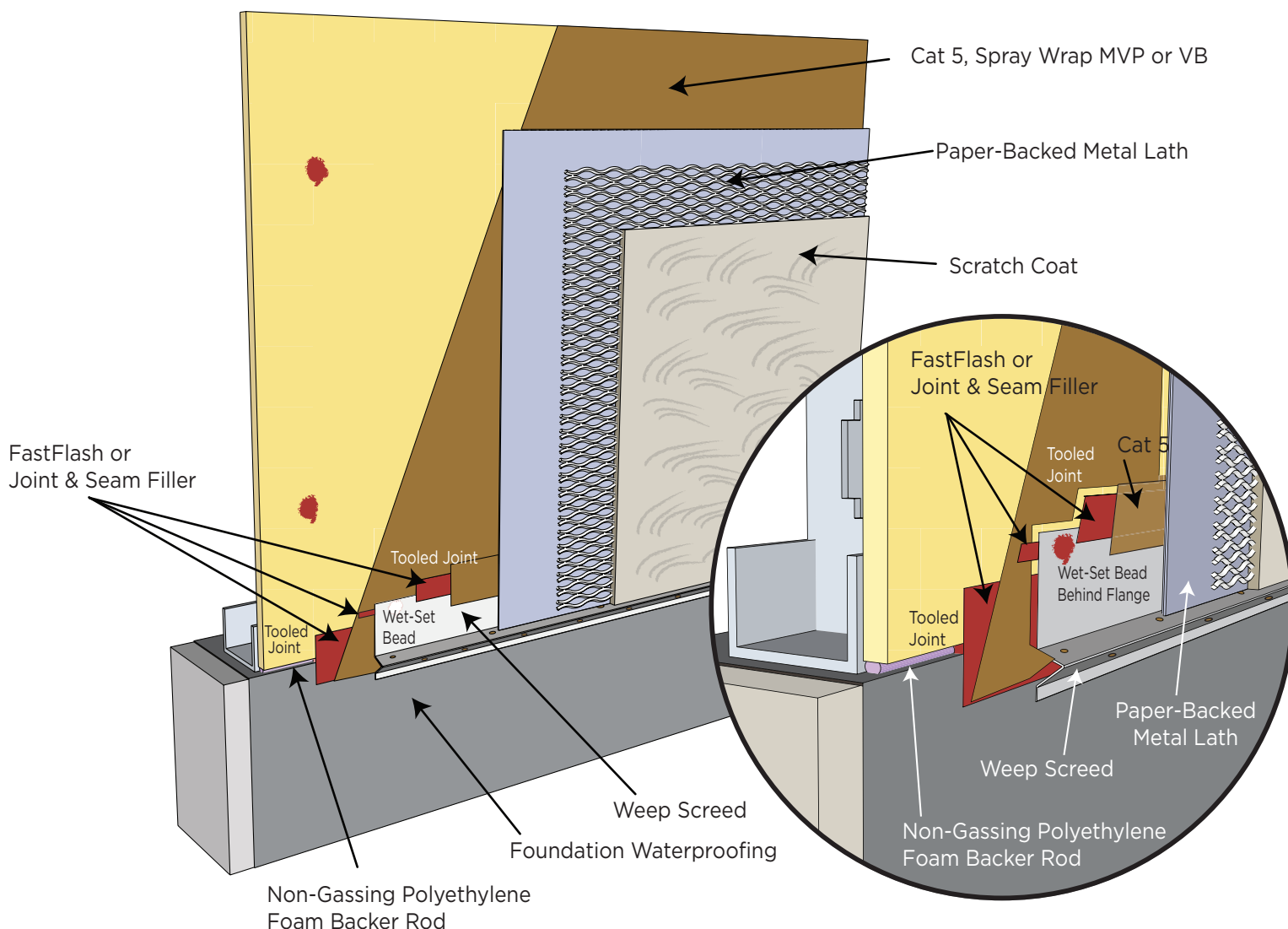

CUSTOMER CARE 800 255 4255 // PROSOCO.COM