

CTP is now part of
the PROSOCO family



PROSOCO

Retain Insulation Board
and Prevent
Unwanted Air Pockets

CTP INSULATION RETAINER PLATE

Easily hold insulation boards tightly in place and maintain thermal barrier integrity

*Insulated cavity walls applied in masonry construction are an integral part of the thermal efficiency of the building. The type of insulation and thickness affect the integrity of its "R" value. It is advantageous to keep the insulation board or mat held firmly to the structure to prevent unwanted air pockets and avoid condensation sources. By utilizing the **CTP Insulation Retainer Plate** with the **CTP-16 Base Plate** and **CTP Wall Tie**, the insulation will be held firmly in place and the masonry will be secure.*

Conventional methods of using a triangle tie, pintle wall tie, or plastic wedges or clips as a means to hold the insulation in place is fraught with challenges. Although possible, the precision of the tie placement relative to the insulation contact can be difficult. The ties have to be perfectly positioned for the size of insulation thickness, if not the insulation is loose. Also, this contact with the tie restricts the wall tie's ability to accommodate in-plane wall movement.

- **Made in America**
- **Does not require perfect alignment with tie**
- **Tie is free to move in plane**
- **Large contact area**
- **Easy to handle**
- **Irregular surface retention**
- **Installs independent of tie**
- **Can be used at seams**
- **Identifiable for inspection purposes**
- **No local crushing of insulation**
- **Use with ANY insulation thickness combination and appropriate CTP-16 Base Plate**
- **Does not rely on tie or pintle contact**

The **CTP Insulation Retainer Plate** will also allow for stacked insulation board to be intimately connected with the back-up. This will let the insulation board thickness be optimized based on insulation needs rather than wall tie designs.

The **CTP Insulation Retainer Plate** is an effective way to mechanically retain board or mat insulation products to a back-up material, even if it has an irregular surface. It is simply pushed on by hand until the desired contact resistance is met. The metal retainer creates a positive retention force of 45 lbs on the board or mat surface without the use of "glues". The **CTP Insulation Retainer Plate** provides over 10 sq inches of contact area which minimizes the crushing event of the insulation compared to other type retainer methods. It can also be used at seams or where boards intersect at the tie. It is available in a stainless steel or galvanized steel to be compatible with the **CTP-16 Base Plate** finish.

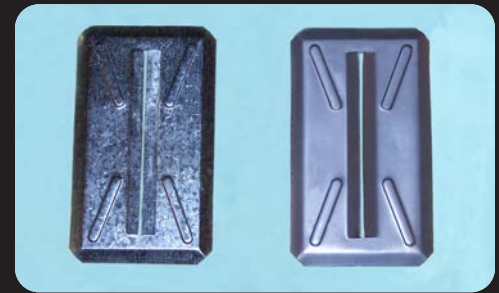

Mill Galvanized per ASTM A-653, G-60
or
Stainless Steel (S.S.) Type 304 per ASTM 167



Use with any insulation thickness combination
and appropriate CTP-16 Base Plate with CTP- Wall Tie

Keeps Insulation Board Held Firmly to the Structure



Construction Tie Products, Inc. is committed to supplying the highest quality masonry tie and construction systems in North America and satisfying all stringent national codes and standards for today's building structures. CTP, Inc. promises to be a reliable product source along with on-time business integrity for all demanding builders. Call anytime for technical assistance or recommendations.

CTP Insulation Retainer Plate Planning Guide

Installation Procedure

- Install the appropriate size CTP-16 base plate per plans and specifications.
 - CTP-16 base plate size should be equal to or greater than the planned insulation thickness to be installed.
(i.e.: 1-1/2" insulation select the CTP-16-2 plate)
- Select CTP Insulation Retainer Plate with a compatible finish. (SS ties = SS plate)
- One CTP Insulation Retainer Plate is required per each CTP-16 base plate.
- Install insulation by pressing insulation board or material over extended CTP-16 base plate projection until the CTP-16 base plate projects through the board. (TIP: Pointed trowel blade passed through the insulation at plate locations speeds installation process)
 - Insulation board thickness combinations are acceptable when using the CTP Insulation Retainer Plate. Total build up insulation thickness must not be greater than the CTP-16 base plate.
- Firmly grip CTP Insulation Retainer Plate with ribs and raised slot faced toward the exterior wall.
- Align the slot of the CTP Insulation Retainer Plate with the projected CTP-16

- anchor and firmly push the plate on the CTP-16 base plate extension by hand until contact is made with the insulation.
- Push the CTP Insulation Retainer Plate to the insulation until the insulation board is in firm contact with the CTP Insulation Retainer Plate.
- Single installation complete; follow same process for the remaining CTP-16 base plates.

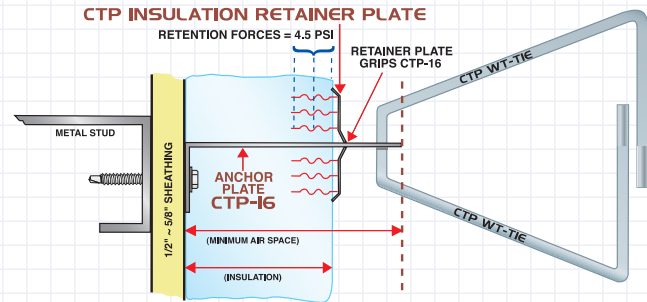

Order Information

Catalog #	Material	Packaging
CTP IR-20	MILL GALVANIZED PER ASTM A-653, G-60	250 PIECES PER BOX
CTP IR-50	STAINLESS STEEL TYPE 304 PER ASTM 167	250 PIECES PER BOX

NOTE: Contact your Construction Tie Products, Inc. representative on order information for the CTP-16 Base Plates and CTP Wall Ties with various sizes and finishes available for your specific project needs.

Warranty

Seller makes no warranty of any kind, expressed or implied, except that the goods sold under this agreement shall be of the standard quality of the seller, and buyer assumes all risk and liability resulting from the use of the goods, whether used singly or in combination with other goods. Seller neither assumes nor authorizes any person to assume for seller any other liability in conjunction with the sale or use of the goods sold, and there is no oral agreement or warranty collateral to or affecting this transaction.

Warning

The information contained in this publication does not constitute any professional opinion or judgement and should not be used as a substitute for competent professional determinations. Each construction project is unique and the appropriate use of this product is the responsibility of the engineers, architects, and other professionals who are familiar with the specific requirements of the project.

CTP is now part of the PROSOCO family PROSOCO



CONSTRUCTION TIE PRODUCTS

3741 Greenway Circle • Lawrence, KS 66046
Phone: (785) 830-7380 • Fax: (219) 874-3626
www.CTPanchors.com

Engineered Anchoring Solutions Provider

Approval